

TECHNICAL DATA SHEET

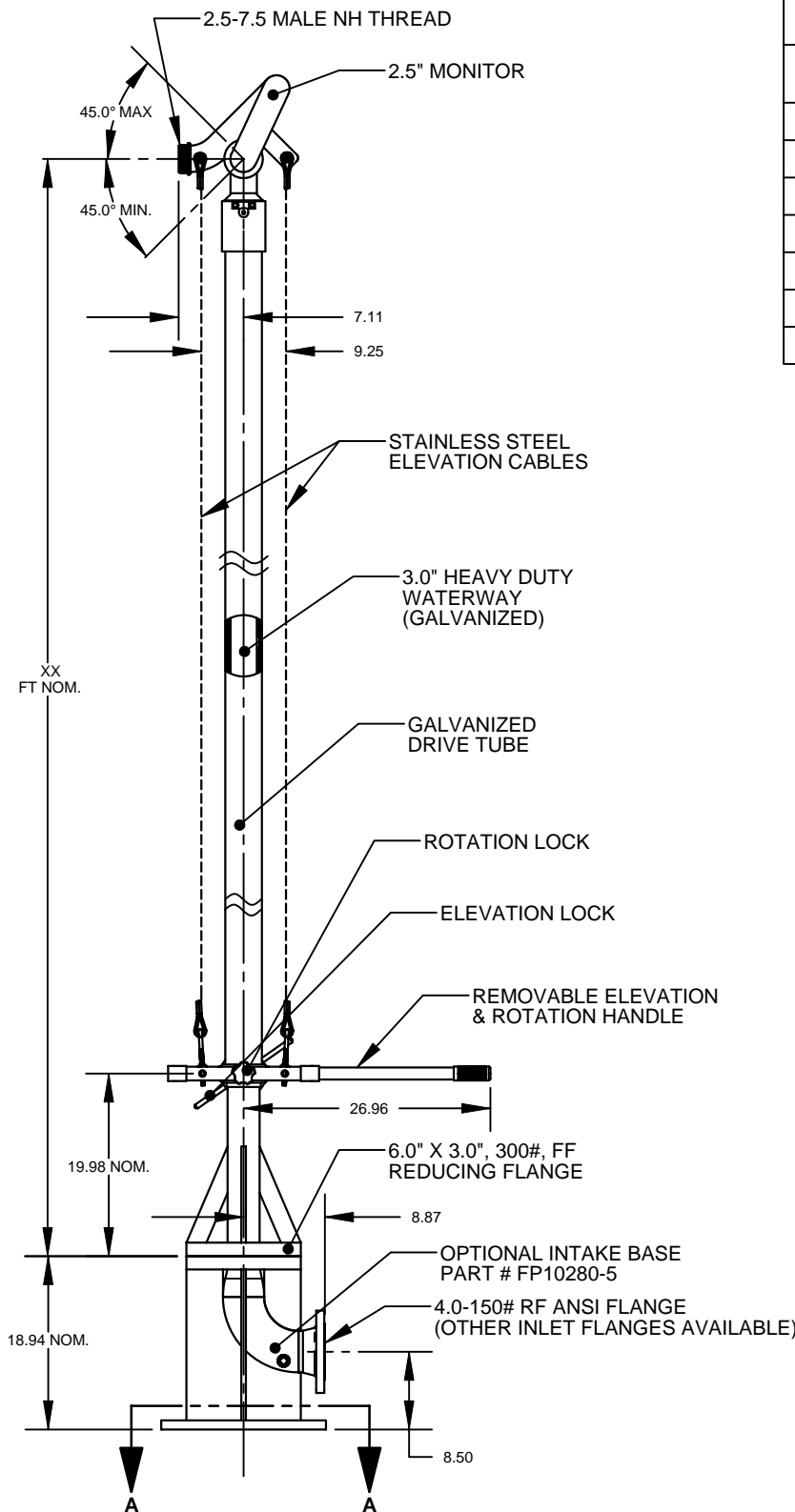

MAX NOZZLE DESIGN THRUST & FLOW

HEIGHT, FT XX	MAX THRUST (LBS)	MAX FLOW * (GPM)	UNIT WT.** (LBS)
10	706	1320	230
12	588	1100	260
14	503	940	290
16	441	825	320
18	393	735	350
20	770	1440	380
22	320	600	410

CAUTION:

DO NOT EXCEED THE MAXIMUM DESIGN THRUST SHOWN ABOVE.

DO NOT INSTALL CLOSER THAN 5 FEET TO STRUCTURE TO ALLOW FOR DEFLECTION.

* MAXIMUM FLOW RATE @ 100 PSI NOZZLE INLET PRESSURE

** UNIT WEIGHT DOES NOT INCLUDE INTAKE BASE.

INSTALL PER PROCEDURE TD-2

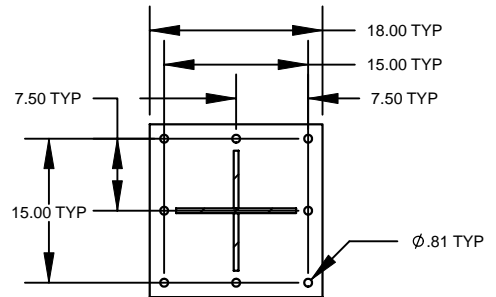

SECTION A-A

OPTIONS:

- ADJUSTABLE AUTO-DRAIN VALVE
- EPOXY COATED WATERWAY
- REMOTE GREASE KIT
- CABLE OPERATED FOG NOZZLE
- HYDRAULIC FOG NOZZLE
- STRAIGHT BORE NOZZLE

		UNLESS OTHERWISE SPECIFIED:		NAME	DATE	FirePro Monitors City of Industry, CA 91744	
		DIMENSIONS ARE IN INCHES TOLERANCES: FRACTIONAL ± ANGULAR: MACH: ± .5 BEND: ± 2 TWO PLACE DECIMAL ±.030 THREE PLACE DECIMAL ±.005		DRAWN	RBS		10/02/07
				CHECKED			
				Q.A.			
		MATERIAL		ELEVATED MONITOR 2.5" FREE STANDING			
		FINISH					
		N/A					
PROPRIETARY AND CONFIDENTIAL	NEXT ASSY	USED ON	FINISH	COMMENTS:		SIZE DWG. NO. A FPEL1250-XX	
THE INFORMATION CONTAINED IN THIS DRAWING IS THE SOLE PROPERTY OF FIREPRO MONITORS. ANY REPRODUCTION IN PART OR AS A WHOLE WITHOUT THE WRITTEN PERMISSION OF FIREPRO MONITORS IS PROHIBITED.	APPLICATION	DO NOT SCALE DRAWING		SCALE: 1:20	WEIGHT:	REV. A	
						SHEET 1 OF 1	